

SITE RULES - PLEASE READ CAREFULLY

These Rules Are In Place To Insure That Every Visitor Can Enjoy Abbey Farm & Surrounding Areas

NO FIRES
CAMPFIRES
OR FIRE PITS



BBQ'S PERMITTED
FOR COOKING FOOD



DOGS ON LEADS
CLEAN UP AFTER THEM



RECYCLE
PLEASE ADHERE TO
THE RECYCLING RULES.
**TO BIG TO RECYCLE...
TAKE IT HOME!**



NOISE
TO STOP BY 10.30PM
MUST BE ADHERED TO
BY ALL CAMPERS



Quiet Time After 10.30pm - This Must Be Adhered to by all campers. After 10.30pm no **music** is to be played, and we ask everyone to return to their own units or tents. We ask you to be mindful and respectful to your fellow campers. No sound systems or noise from devices allowed at all after this time - complete silence after 12pm - we are a family campsite.

Children must be accompanied by an adult at all times around site including the amenity blocks, bistro and barn. **Antisocial behavior** will not be **tolerated**, we issue a two warning policy, if you receive more than two warnings then you will be asked to leave immediately.



If you are in a group of **three tents** or more & want to pitch together we do require a good behavior bond of **£50.00 per tent** which is refundable on departure. This bond is taken to ensure that all groups abide by the campsite rules, to ensure that everyone staying with us has an enjoyable stay.

HELP ON HOW TO PITCH UP

ELECTRIC PITCH

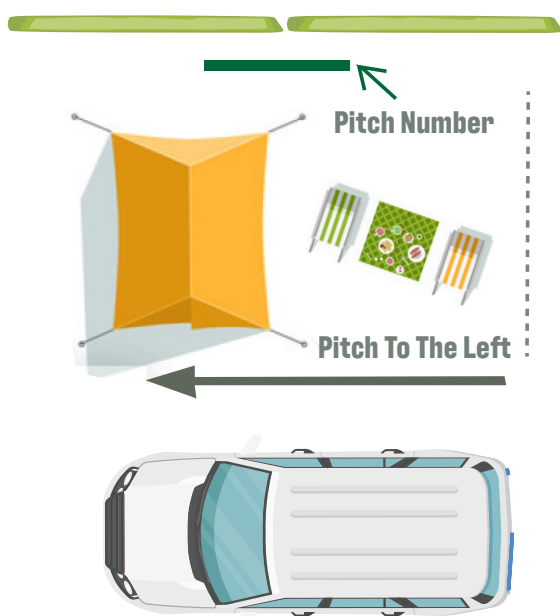

NON-ELECTRIC PITCH

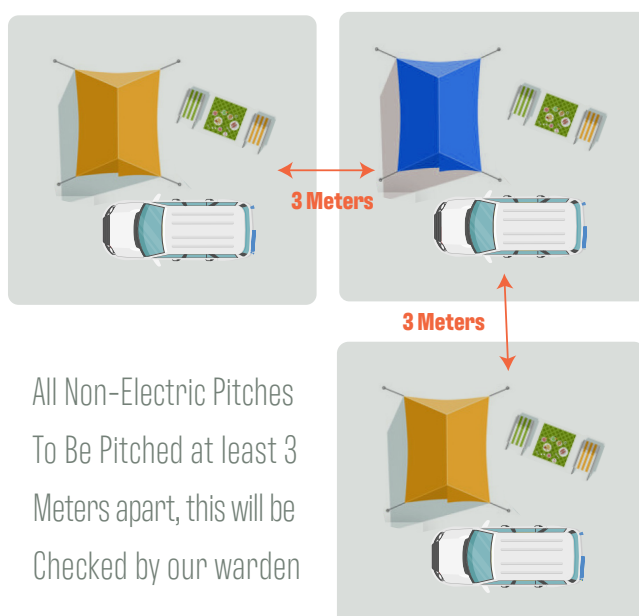

Maximum tent size 5M wide a 4-6 man tent. If on an electric pitch you tent must comfortably fit within the pitch, your car must be able to be parked at the front of your pitch, within the pitch markings. **Maximum Gazebo Size: 3x3m**



Vehicles: In busy periods all extra vehicles will be required to park in a designated overflow parking area. One vehicle parked next to pitch only.



Electric pitches: Electric hook ups have a low voltage supply, please do not use household appliances. A fine of £50 will apply for using splitters on electric hook ups. Electric car charging not permitted from your pitch.



RECYCLING: Recycling law applies to all business in Wales. What To Recycle: Food - **Paper & Card - Glass - Metal, Plastic & Cartons**

If You Can't Fit It In The Bins Provided (Its To Large) Please Take It Home With You.

Fines of £300-£500 will apply for breaking the law and you will be reported to local authorities.

Out Of
Hours

If You Are Unsure Of Any Of The Above Please Ask For Further Assistance Before Pitching Up

WARDEN ASSISTANCE 07958718892